

# OUTDOOR 3-OUTLET TIMER WITH REMOTE CONTROL

## WARNING:

- The device must be mounted in a vertical position with the receptacle facing downward and with the receptacle at least 1.4 M above the ground level.
- Let the switch hang downward so moisture does not accumulate in the outlet.
- Suitable for Outdoor Use, Store indoors when not in use. Not for water immersion or for use were directly exposed to water

## INSTALLATION INSTRUCTIONS

### Installation

- Mount the timer onto a wall near a grounded electrical outlet with the photo sensor facing outward.

Note: To ensure proper operation of automatic function, ensure photocell sensor is shielded from all nighttime sources of light, i.e. floodlights.

- Insert nail or screw (not included) into mounting surface. Nail or screw head must extend at least 3/16 in. out from the wall. Hang the receiver from the slot on back of the unit onto the nail or screw. Plug the power supply cord of the receiver into the outlet.
- Plug the device cord into any of the three receptacles at the bottom of the receiver.

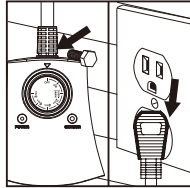

## OPERATING INSTRUCTIONS

### 1. Button Layout

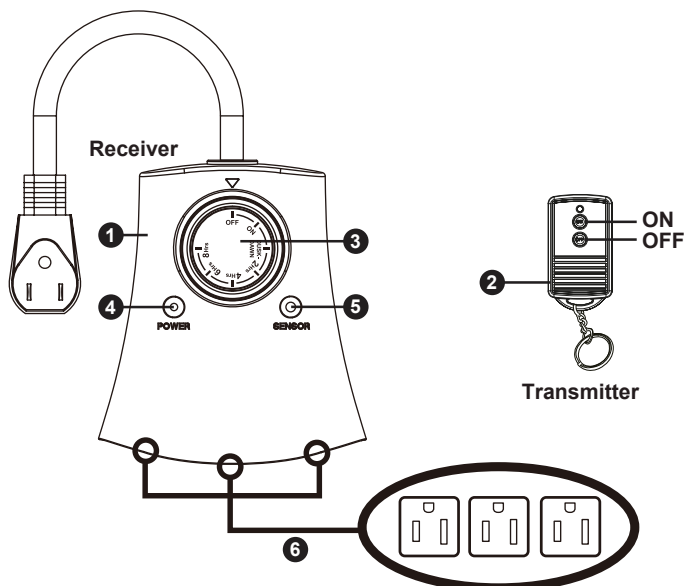

1. Timer unit: The timer will control an array of devices by setting the dial.
2. Remote control:
  - ON: When the on button is pressed, it will override the timer's current program to on function.
  - OFF: When the off button is pressed, it will override the timer's current program to off function.
  - Remote indicator light: The LED light indicates that the ON or OFF button is being pressed.
3. Timer dial: Rotate the dial on the timer to select one of the following settings

Dial position	Function
OFF	Power OFF
ON	Power ON
DUSK-DAWN	Powers ON at dusk, OFF at dawn
2 Hrs	ON at dusk – OFF in 2 hours
4 Hrs	ON at dusk – OFF in 4 hours
6 Hrs	ON at dusk – OFF in 6 hours
8 Hrs	ON at dusk – OFF in 8 hours

4. Power indicator light: The power indicator light indicates that the timer is on.
5. Photo sensor: The sensor will sense for light and dark, and direct the timer to act accordingly.
6. Outlets: The three outlets located on the bottom of the timer allows the user to plug an array of devices into it.

### 2. Timer and remote interaction

Your timer includes a remote control with temporary override:

- Temporary override ON: turns the timer ON for desired settings (2, 4, 6 or 8 Hours). Please note that if the timer is set to a 2-, 4-, 6- or 8-hour mode, it will come on at dusk and will turn off 2, 4, 6, or 8 hours later.
- Temporary override OFF: turns the timer OFF.

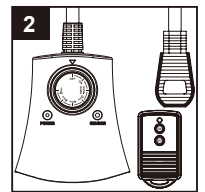

Timer Dial position	Using the Remote
OFF	Press the remote and the timer will turn ON/OFF
ON	Press the remote and the timer will turn ON/OFF
DUSK-DAWN 2, 4, 6 or 8 HRS	Press the remote and it will go into a manual restart mode. The timer will restart from '0' and count until it reaches the time set on the dial, or dawn. Please refer to examples below for further explanation.

### 3. Examples

- Timer set to DUSK-DAWN When DUSK = 6:00 PM and DAWN = 5:00 AM.
  - If at 4 :00 PM REMOTE activated to ON --> TIMER OUTPUT ON and stays ON until 5:00 AM.
  - Next day, ON at DUSK, OFF at DAWN.
  - If at 10:00 PM REMOTE activated to OFF --> TIMER OUTPUT OFF = 10:00 PM and stays OFF until DAWN next day.
  - Next day ON at DUSK, OFF at DAWN.
- If TIMER setting is 2 HOURS (or 4, 6, 8 HOURS and so on) DAY OR NIGHT TIME REMOTE ON --> TIMER OUTPUT ON 2 HOURS (4, 6, 8 HOURS) then OFF.
  - When DUSK --> TIMER OUTPUT ON 2 HOURS (4, 6, 8 HOURS) then OFF. If DUSK is at 6:00 PM:
    - (1) If at 5:00 PM REMOTE set ON, then TIMER OUTPUT ON immediately until 7:00 PM.
    - (2) TIMER ON = 6:00 PM, TIMER OFF = 8:00 PM. If at 1:00 PM REMOTE set ON, then TIMER OUTPUT turns ON until 3:00 PM.
    - (3) TIMER ON = 6:00 PM. If at 7:00 PM REMOTE set ON TIMER OUTPUT ON until 9:00 PM (as time count restarted at time remote activates to ON).
    - (4) TIMER ON = 6:00 PM. If at 7:00 PM REMOTE set OFF, then TIMER OUTPUT turns OFF immediately until next day.

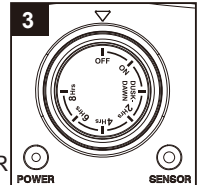

## MAINTENANCE

### Battery Handling and Usage

**WARNING:** Keep batteries away from children and pets.

- Follow the battery manufacturer's safety and usage instructions.
- Insert the battery observing the proper polarity (+/-) as indicated inside Battery Compartment.
- Remove a spent or discharged battery from the product. Remove the battery when not using the product for an extended period.
- Never throw batteries into a fire. Do not expose batteries to fire or other heat sources.
- Dispose or recycle spent / discharged batteries in compliance with all applicable laws. For detailed information contact your local solid waste authority.
- Battery contains mercury. Do not put in trash. Recycle or manage as hazardous waste.

### Remote control unit

- RF (radio frequency) transmitter is powered by one 12V 23A alkaline battery.
- Red indicator light (1.)
- Flickers when transmitting.
- Remote operates the receiver.
- Chain and key ring (2.) for pocket or purse key ring use
- Replace battery when red indicator light (1.) does not flicker when a button is pressed.

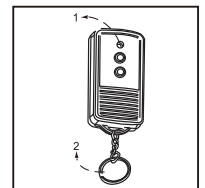

### Battery replacement

- Remove the battery compartment cover from the back of the remote control by sliding the cover in the direction that its treads curve.
- Remove the spent battery and place a new DC 12V Type 23A battery into the battery compartment, correctly observing the polarity indications (+/-) inside the battery compartment.
- Replace the battery compartment cover.

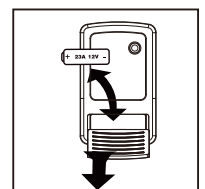

- Non-rechargeable batteries are not to be recharged. Do not mix different types of batteries such as alkaline, carbon-zinc, or rechargeable batteries. Do not mix old and new batteries. Batteries are to be inserted with the correct polarity. Exhausted batteries are to be removed from the product.
- One 23A alkaline battery. Battery included.
- DO NOT DISPOSE OF BATTERIES IN FIRE. BATTERIES MAY EXPLODE OR LEAK.

## HELPFUL TIPS

- Before using your timer, please read the following instructions carefully.
- When set to "ON", the timer will provide continual power to attached devices until the timer is switched to "OFF", or to any of the other operating modes.

## SAFETY INFORMATION

### SPECIFICATIONS:

14/3 AWG SJTW vinyl cord

### RATINGS:

125 V ac 60 Hz,

15 A Resistive,

15 A General Use,

1,000 W Tungsten,

500 VA Electronic Ballast,

1/2HP. 120 V ac 60 Hz, 8.3 A Ballast

### Federal Communications Commission Interference Statement

This equipment has been tested and found to comply with the limits for Class B digital device, pursuant to part 15 of the FCC Rules. These limits are designed to provide reasonable protection against harmful interference in a residential installation. This equipment generates, uses and can radiate radio frequency energy and, if not installed and used in accordance with the instructions, may cause harmful interference to radio or television reception, which can be determined by turning the equipment off and on, the user is encouraged to try to correct the interference by one or more of the following measures:

- Reorient or relocate the receiving antenna.
- Increase the separation between the equipment and the receiver.
- Connect the equipment into an outlet on a circuit different from that to which the receiver is connected.
- Consult the dealer or an experienced radio/TV technician for help.

This device complies with Part 15 of the FCC Rules. Operation is subject to the following two conditions: (1) This device may not cause harmful interference, and (2) this device must accept any interference received, including interference that may cause undesired operation of the device.

FCC Caution: Any changes or modifications not expressly approved by the party responsible for compliance could void the user's authority to operate this equipment.

## TROUBLESHOOTING

	Solution
The lights do not turn on, even when the timer is in the "ON" position.	Ensure the lights are functional by plugging them directly into the outlet.
	Be sure that the lights are in the "ON" position if they have their own switch.
	Be sure that the outlet that the timer is plugged into is active.
	Be sure that the dial is fully turned to the "ON" position by listening for the clicking sound.
The lights do not turn on 2,4,6, or 8 hrs. after dusk.	Confirm that the timer is plugged properly into the outlet, and that the light is turned on if there is a switch.
	Be sure that the timer is not near ambient light sources.
The lights do not turn on and off via remote control.	Confirm remote operation after replacing batteries.



Made in China  
SAVE THESE INSTRUCTIONS!